

LE BLANC MESNIL

BATIMENT D

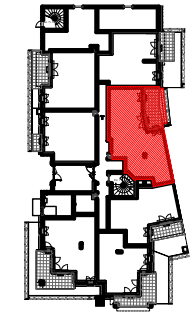

RDC







LOGEMENT 3 PIECES

LOGEMENT	BATIMENT	ETAGE	APPART.
D037	D	RDC	7

SEJOUR / CUISINE	28,47 m ²
DGT	3,84 m ²
CHAMBRE 1	13,14 m ²
CHAMBRE 2	11,18 m ²
WC	1,87 m ²
SDB	5,82 m ²
SURFACE TOTAL HABITABLE PREVISIONNELLE	64.32 m²
TERRASSE	11,06 m ²
JARDIN	5,75 m ²
SURFACE TOTAL PRIVATIVE PREVISIONNELLE	81.13 m²

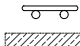
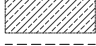
LEGENDE :

- PF : Porte fenêtre
- AV : Allège vitrée
- F : Fenêtre
- VR : Volet roulant
- VB : Volet battant
- GC : Garde corps
- PV : Pare vue
- R : Réfrigérateur
- LL : Lave linge
- LV : Lave vaisselle
- C : Cuisson
- LC : Linéaire complémentaire
- TRI : Tri sélectif
- RP : Robinet de puisage

-  Placard
-  Tableau électrique
-  Sèche serviette
-  Soffite
-  Faux plafond
-  Poutre
-  Cloison fusible
-  Gravillon

PROVISOIRE

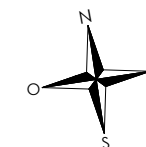
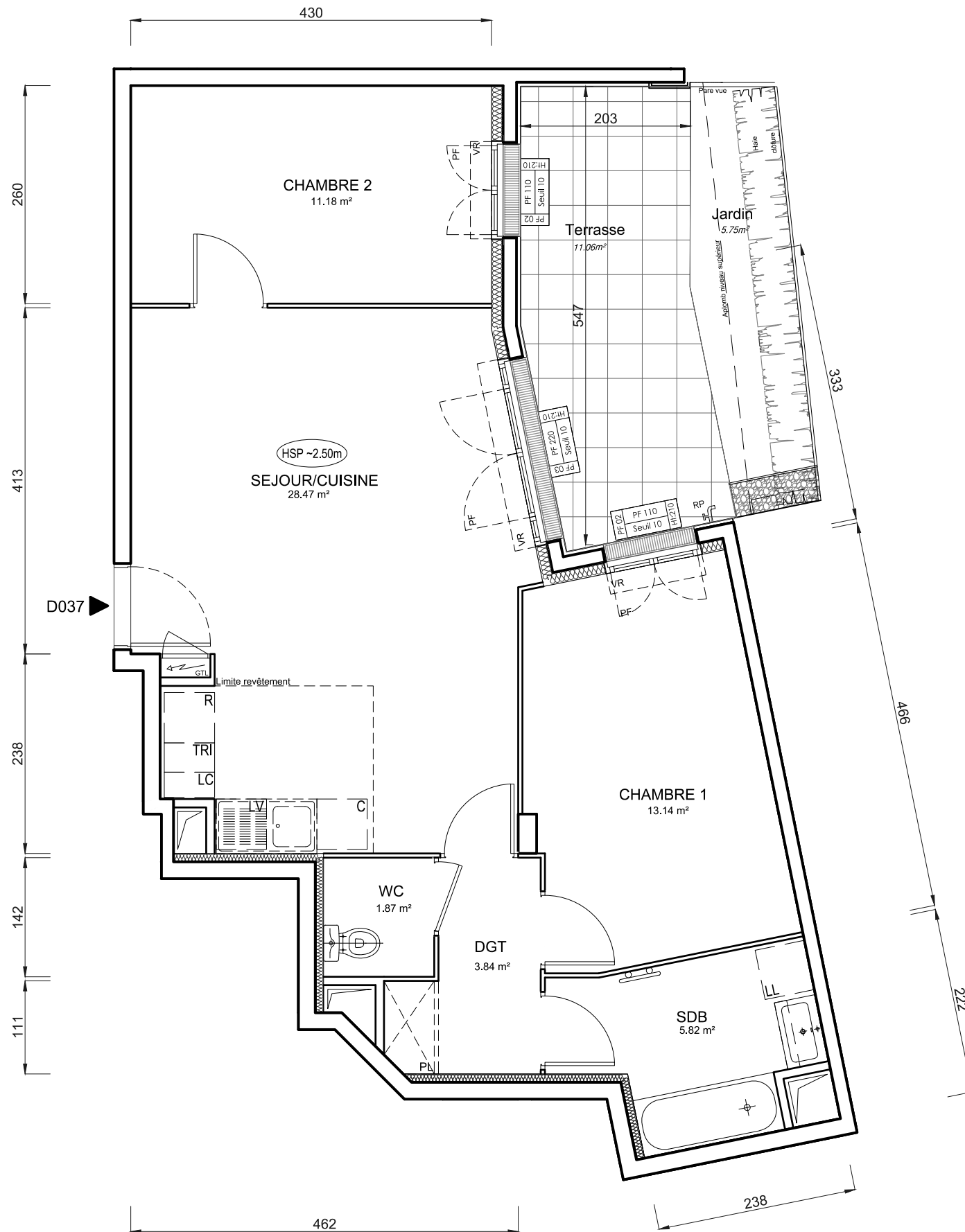

INDICE : MODIFIÉ LE :
DATE : 15/01/2024 ECHELLE :

